

Let your spirit set sail



Eye of the Wind

sailing plan 2017 / 2018

No. Voyage _____ Ports and Dates of Embarkation & Debarkation _____ Fare (€)

The Canary Islands: Volcanic Cones in the Atlantic Ocean

50	Volcanic Islands in the Atlantic	Lanzarote (ESP) – Lanzarote (ESP)	Wed 11/01/2017 – Tue 11/07/2017	1.500
51	Pearls of the Canary Islands	Lanzarote (ESP) – Tenerife (ESP)	Tue 11/07/2017 – Tue 11/14/2017	1.750



The Lesser Antilles: Pearls of the Caribbean

53	Caribbean Christmas & New Year's	Marigot – Marigot (St. Martin)	Sat 12/23/2017 – Sat 01/06/2018	2.400
53a	Christmas in the Caribbean	St. Martin – British Virgin Islands	Sat 12/23/2017 – Sat 12/30/2017	1.680
53b	New Year's on the B.V.I.	British Virgin Islands – St. Martin	Sat 12/30/2017 – Sat 01/06/2018	1.680
02	The Leeward Islands	Marigot – Marigot (St. Martin)	Sat 01/06/2018 – Fri 01/12/2018	fully booked
03	A Caribbean Dream	St. Martin – Antigua	Fri 01/12/2018 – Fri 01/19/2018	1.680
04	Pearls of the Lesser Antilles	Antigua – Barbuda – Antigua	Fri 01/19/2018 – Fri 01/26/2018	1.680
05	From Antigua to Guadeloupe	Antigua – Guadeloupe	Fri 01/26/2018 – Fri 02/02/2018	1.680
06	'round Guadeloupe	Guadeloupe – Guadeloupe	Fri 02/02/2018 – Fri 02/09/2018	fully booked
07	Caribbean Carnival in Dominica	Guadeloupe – Guadeloupe	Fri 02/09/2018 – Fri 02/16/2018	1.680
08	5 Days Tall Ship Taster Trip	Guadeloupe – Antigua	Fri 02/16/2018 – Wed 02/21/2018	1.200
09	In the Footsteps of Columbus	Antigua – St. Martin	Wed 02/21/2018 – Wed 02/28/2018	1.680

Adventurous Atlantic-Crossing

10	880 Miles of Bluewater Sailing	St. Martin – Bermuda	Fri 03/02/2018 – Tue 03/13/2018	1.550
11	Atlantic Crossing under Sails	Bermuda – Horta (Azores)	Wed 03/14/2018 – Mon 04/02/2018	1.990
12	From the Azores to Normandy	Horta (Azores) – Cherbourg (FRA)	Wed 04/04/2018 – Wed 04/18/2018	1.470
13	Shores of the English Channel	Cherbourg (FRA) – Ijmuiden (NED)	Wed 04/18/2018 – Sun 04/22/2018	890
14	Rolling Home to Hamburg	Ijmuiden (NED) – Hamburg (GER)	Sat 05/05/2018 – Wed 05/09/2018	890

NEW

Tidal Waters: North Sea and Thames Estuary

16	Wind and Waves	Hamburg (GER) – Gravesend (ENG)	Tue 05/15/2018 – Mon 05/21/2018	1.560
XX	*to be announced*	Gravesend (ENG) – London (ENG)	dates and fares in planning	
XX	*to be announced*	London (ENG) – Ramsgate (ENG)	dates and fares in planning	
21	Ebb and Flow of the North Sea	Ramsgate (ENG) – Emden (GER)	Sun 05/27/2018 – Sat 06/02/2018	1.440
22	Along the Frisian Shoreline	Emden (GER) – Kiel (GER)	Sun 06/03/2018 – Fri 06/08/2018	1.200

NEW

Summer trips on the Baltic Sea: Denmark, South Sweden, Åland, Finland

23	Tall Ship Taster Trip	Kiel (GER) – Kiel (GER)	Fri 06/08/2018 – Tue 06/12/2018	960
27	Setting Course for Copenhagen	Kiel (GER) – Copenhagen (DK)	Wed 06/27/2018 – Sun 07/01/2018	960
30	Bothnian Sea	Stockholm (SWE) – Turku (FIN)	Mon 07/16/2018 – Sat 07/21/2018	fully booked
31	The Baltic Sea in Summer	Turku (FIN) – Karlskrona (SWE)	Sat 07/21/2018 – Sat 07/28/2018	1.680
32	Islands of the Baltic Sea	Karlskrona (SWE) – Stralsund (GER)	Sat 07/28/2018 – Fri 08/03/2018	1.440
33	Four days in the Baltic Sea	Stralsund (GER) – Rostock (GER)	Fri 08/03/2018 – Tue 08/07/2018	1.080

To get detailed information about a selected trip, please click on the corresponding line. You will thereby get connected to our website ► www.eyeofthewind.net

Prices are per passenger, including voyage, cabin, meals, unlimited coffee, tea, water and soft drinks, as well as port charges, and tax. Alcoholic beverages and personal on board expenses are not included. Trainees aged from 16 to 25 years get a discount of 50 % on all voyages (except daytrips).

Accommodation: comfortable two-berth cabins with cold / hot water, shower, lavatory, and air conditioning system. Not included: transportation to and from ports of arrival and departure, shore excursions, and alcoholic beverages. Ports and destinations may be subject to change due to unpredictable weather conditions. Please contact us for individual counselling.

All information as of October 2017. Itinerary may be subject to change without prior notice.



FORUM train & sail GmbH
Mandichost. 18
86504 Merching / GERMANY
www.eyeofthewind.net



Please contact: Ms. Britta Altenhoff
Phone: +49 (0)8233 381-546
Fax: +49 (0)8233 381-9943
E-mail: info@eyeofthewind.net

Eye of the Wind Portrait

Built: 1911
Yard: C. H. Luhring Werft, Brake, Germany
Length: 40.23 m (132') over all
Beam: 7.01 m (23')
Draft: 2.70 m (9')
Rigging Type: Brig
Sailing Area: 750 sqm
Engine: 600 HP
Speed: 8 knots
Hull: Steel
Deck: Teak

Accommodation: 6 guest cabins (16 berth total)
4 crew cabins (10 berth total)

Saloons: Lower saloon, library, DVD, upper saloon, open main deck

Navigation: Radar, GPS

Communication: Radio (worldwide), satellite phone, fax, internet

Safety: Up-to-date safety-, fire prevention- and rescue equipment, all according to international directives

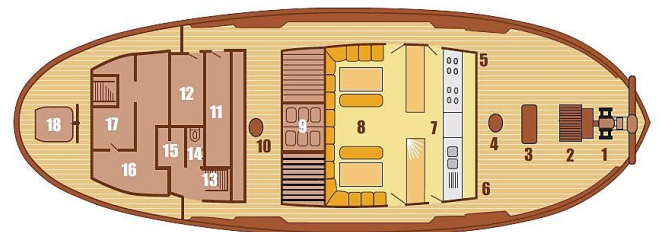
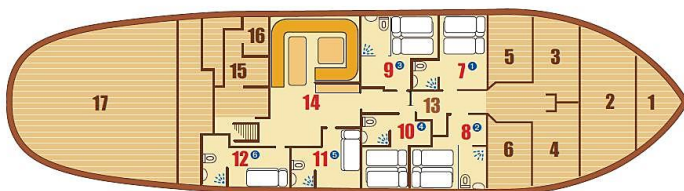

- 1 Kettenkasten
Chain locker
- 2 Mannschaftskabine
Crew cabin
- 3 Mannschaftskabine
Crew cabin
- 4 Mannschafts-WC/Dusche
Crew showers and heads
- 5 Mannschaftskabine
Crew cabin
- 6 Mannschaftskabine
Crew cabin

- 7 Gästekabine Ø, 3 Kojen
Guest cabin (1), 3 berth
- 8 Gästekabine Ø, 3 Kojen
Guest cabin (2), 3 berth
- 9 Gästekabine Ø, 3 Kojen
Guest cabin (3), 3 berth
- 10 Gästekabine Ø, 3 Kojen
Guest cabin (4), 3 berth
- 11 Gästekabine Ø, 2 Kojen
Guest cabin (5), 2 berth
- 12 Gästekabine Ø, 2 Kojen
Guest cabin (6), 2 berth

- 13 Kajüstreppe
Companionway
- 14 Unterer Salon
Lower Saloon
- 15 Kühlraum
Refrigerated Store
- 16 Gefrierkammer
Freezer
- 17 Maschinenraum
Engine room

- 1 Ankerwinde
Anchor Windlass
- 2 Luke Mannschaftsunterkunft
Fore side hatch
- 3 Vordere Luke / Notausstieg
Forward hatch
- 4 Fockmast
Foremast
- 5 Gaskasten
Gas locker
- 6 Gemüsechrank
Vegetable locker

- 7 Kombüse
Galley
- 8 Speisesalon
Dining Saloon
- 9 Luke Mittschiff
Midships hatch
- 10 Hauptmast
Mainmast
- 11 Werkstatt
Workshop
- 12 Waschraum
Laundry

- 13 Kajüstreppe
Aft companionway
- 14 Toilette
Toilet
- 15 Luke Maschinenraum
Engine room hatch
- 16 Kapitänskabine
Captain's cabin
- 17 Kartenraum
Chartroom
- 18 Schiffsrudder
Ship's wheel

